

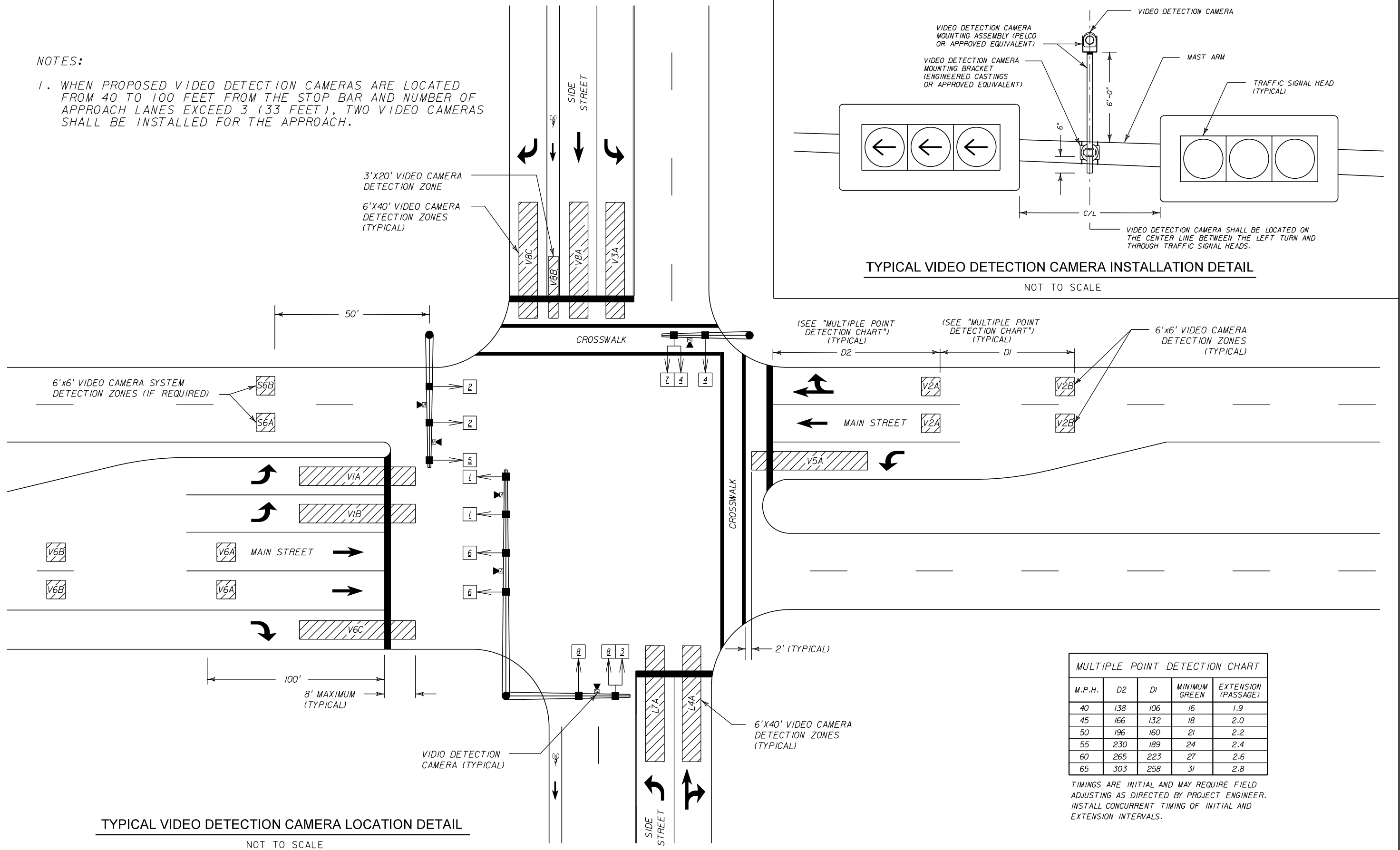

NOTES:

1. WHEN PROPOSED VIDEO DETECTION CAMERAS ARE LOCATED FROM 40 TO 100 FEET FROM THE STOP BAR AND NUMBER OF APPROACH LANES EXCEED 3 (33 FEET), TWO VIDEO CAMERAS SHALL BE INSTALLED FOR THE APPROACH.



REVISIONS					
DATE	BY	DESCRIPTION	DATE	BY	DESCRIPTION



Collier County Traffic Operations
2885 South Horseshoe Drive
Naples, Florida 34104

Phone: (239) 252-8260
Fax: (239) 252-5868

COLLIER COUNTY

GROWTH MANAGEMENT DIVISION

VIDEO DETECTION
DETAILS

SHEET NO.
TSP-25